



# FAIRFIELD GRANDE



**KAY BUILDERS**  
6 DECADES OF EXCELLENCE

# FAIRFIELD GRANDE

*Square Feet: 2923*

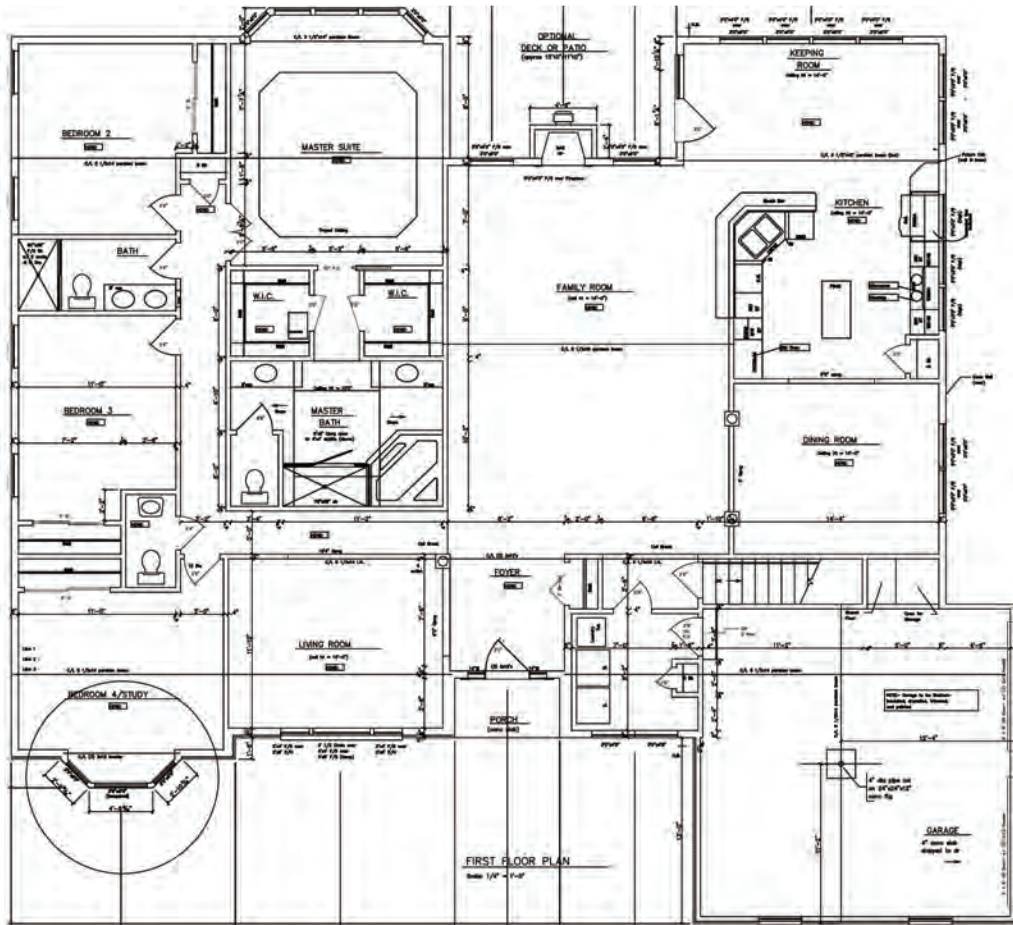

With its hipped roof, double circle top windows, an angled bay, side car garage entry and a choice of masonry or stucco façades, the Fairfield is as current as the newest trends...

Upon entering the home, the eye is drawn to elegant spacious family room with a well-appointed fireplace. Located off the foyer, the Living Room offers a quiet place to entertain guests.

The informal portion of the home features a kitchen with angled double bowl sink, snack counter and cathedral ceiling breakfast area adjacent to the family room—ideal for small gatherings. And for larger groups, the flow between dining room and family room works wonders.

The owners suite and 2 (or 3) additional bedrooms, located on either side of the 2nd bath, are positioned to provide convenience and easy access. Great for the modern-day lifestyle!



**KAY BUILDERS**  
6 DECADES OF EXCELLENCE